



**Licensing Act 2003
Section 24
Premises licence**

Licensing, City of London
PO Box 270 Guildhall, London EC2P 2EJ

Premises licence number

LN/200506202

Part 1 - Premises details

Postal address of premises, or if none, ordnance survey map reference or description
Gremio De London, 26A Savage Gardens

Post town
London

Post code
EC3N 2AR

Telephone Number

Where the licence is time limited - the dates

Licensable activities authorised by the licence

Alcohol Sales, Recorded Music, Late Night Refreshment

The times the licence authorises the carrying out of licensable activities

Alcohol Sales

Sunday	12:00 - 00:00	-
Monday	11:00 - 00:00	-
Tuesday	11:00 - 00:00	-
Wednesday	11:00 - 00:00	-
Thursday	11:00 - 01:00	-
Friday	11:00 - 02:00	-
Saturday	11:00 - 02:00	-

Recorded Music

Sunday	12:00 - 00:00	-
Monday	12:00 - 00:00	-
Tuesday	12:00 - 00:00	-
Wednesday	12:00 - 00:00	-
Thursday	12:00 - 01:00	-
Friday	12:00 - 02:00	-
Saturday	12:00 - 02:00	-

The times the licence authorises the carrying out of licensable activities cont'd

Late Night Refreshment

Sunday	23:00 - 00:00	-
Monday	23:00 - 00:00	-
Tuesday	23:00 - 00:00	-
Wednesday	23:00 - 00:00	-
Thursday	23:00 - 01:00	-
Friday	23:00 - 02:00	-
Saturday	23:00 - 02:00	-

The opening hours of the premises

Opening Hours

Sunday	10:00 - 00:30	-
Monday	10:00 - 00:30	-
Tuesday	10:00 - 00:30	-
Wednesday	10:00 - 00:30	-
Thursday	10:00 - 01:30	-
Friday	10:00 - 02:30	-
Saturday	10:00 - 00:30	-

Where the licence authorises supplies of alcohol - whether these are on and/or off supplies

On the Premises

Part 2

Name, (registered) address, telephone number and email (where relevant) of holder of premises licence

Gremio De London Ltd
[REDACTED] Malham Road
London
SE23 1AH

Registered number of holder, for example company number, charity number (where applicable)

10166100

Name, address and telephone number of designated premises supervisor where the premises licence authorises for the supply of alcohol

Maxwell Alderman
[REDACTED] Perry Hill
London
SE6 4EZ

Personal licence number and issuing authority of personal licence held by designated premises supervisor - where the premises licence authorises for the supply of alcohol

LN/000002437 - Greenwich

Date granted 22nd June 2017



Director of Markets & Consumer Protection

Annex 1 - Mandatory conditions

Alcohol

1. No supply of alcohol may be made under the Premises Licence –
 - (a) At a time when there is no Designated Premises Supervisor in respect of the Premises Licence; or
 - (b) At a time when the Designated Premises Supervisor does not hold a Personal Licence or his Personal Licence is suspended.
2. Every supply of alcohol under the Premises Licence must be made, or authorised by a person who holds a Personal Licence.
3. (1) The responsible person must ensure that staff on relevant premises do not carry out, arrange or participate in any irresponsible promotions in relation to the premises.
 - (2) In this paragraph, an irresponsible promotion means any one or more of the following activities, or substantially similar activities, carried on for the purpose of encouraging the sale or supply of alcohol for consumption on the premises.
 - a) games or other activities which require or encourage, or are designed to require or encourage, individuals to –
 - (i) drink a quantity of alcohol within a time limit (other than to drink alcohol sold or supplied on the premises before the cessation of the period in which the responsible person is authorised to sell or supply alcohol), or
 - (ii) drink as much alcohol as possible (whether within a time limit or otherwise);
 - b) provision of unlimited or unspecified quantities of alcohol free or for a fixed or discounted fee to the public or to a group defined by a particular characteristic in a manner which carries a significant risk of undermining a licensing objective;
 - c) provision of free or discounted alcohol or any other thing as a prize to encourage or reward the purchase and consumption of alcohol over a period of 24 hours or less in a manner which carries a significant risk of undermining a licensing objective;
 - d) selling or supplying alcohol in association with promotional posters or flyers on, or in the vicinity of, the premises which can reasonably be considered to condone, encourage or glamorise anti-social behaviour or to refer to the effects of drunkenness in any favourable manner.
 - e) dispensing alcohol directly by one person into the mouth of another (other than where that other person is unable to drink without assistance by reason of disability).
4. The responsible person must ensure that free potable water is provided on request to customers where it is reasonably available.
5. (1) The premises licence holder or club premises certificate holder must ensure that an age verification policy is adopted in respect of the premises in relation to the sale or supply of alcohol.

(2) The designated premises supervisor in relation to the premises licences must ensure that the supply of alcohol at the premises is carried on in accordance with the age verification policy.

(3) The policy must require individuals who appear to the responsible person to be under 18 years of age (or such older age as may be specified in the policy) to produce on request, before being served alcohol, identification bearing their photograph, date of birth and either:-

(a) a holographic mark or

(b) an ultraviolet feature.

6. The responsible person shall ensure that –

(a) where any of the following alcoholic drinks is sold or supplied for consumption on the premises (other than alcoholic drinks sold or supplied having been made up in advance ready for sale or supply in a securely closed container) it is available to customers in the following measures –

(i) beer or cider: ½ pint;

(ii) gin, rum, vodka or whisky: 25 ml or 35 ml; and

(iii) still wine in a glass: 125 ml; and

(b) these measures are displayed in a menu, price list or other printed material which is available to customers on the premises; and

(c) where a customer does not in relation to a sale of alcohol specify the quantity of alcohol to be sold, the customer is made aware that these measures are available.

Minimum Drinks Pricing

1. A relevant person shall ensure that no alcohol is sold or supplied for consumption on or off the premises for a price which is less than the permitted price.

2. For the purposes of the condition set out in paragraph 1 –

(a) “duty” is to be construed in accordance with the Alcoholic Liquor Duties Act 1979

(b) “permitted price” is the price found by applying the formula –

$$P = D + (D \times V)$$

Where –

(i) P is the permitted price

(ii) D is the amount of duty chargeable in relation to the alcohol as if the duty were charged on the date of the sale or supply of the alcohol, and

(iii) V is the rate of value added tax chargeable in relation to the alcohol as if the value added tax were charged on the date of the sale or supply of the alcohol;

(c) “relevant person” means, in relation to premises in respect of which there is in force a premises licence –

(i) The holder of the premises licence

- (ii) The designated premises supervisor (if any) in respect of such a licence, or
 - (iii) The personal licence holder who makes or authorises a supply of alcohol under such a licence;
- (d) "relevant person" means, in relation to premises in respect of which there is in force a club premises certificate, any member or officer of the club present on the premises in a capacity which enables the member or officer to prevent the supply in question; and
- (e) "value added tax" means value added tax charged in accordance with the Value Added Tax Act 1994.
3. Where the permitted price given by Paragraph (b) of paragraph 2 would (apart from the paragraph) not be a whole number of pennies, the price given by that sub-paragraph shall be taken to be the price actually given by that sub-paragraph rounded up to the nearest penny.
4. (1) Sub-paragraph (2) applies where the permitted price given by Paragraph (b) of paragraph 2 on a day ("the first day") would be different from the permitted price on the next day ("the second day") as a result of a change to the rate of duty or value added tax.
- (2) The permitted price which would apply on the first day applies to sales or supplies of alcohol which take place before the expiry of the period of 14 days beginning on the second day.

Annex 2 - Conditions consistent with the Operating Schedule

Annex 3 - Conditions attached after a hearing by the licensing authority

The following conditions/resolutions were agreed by the City of London's Licensing Sub Committee at a hearing held on 22nd June 2017

- 1. The premises will install and maintain a comprehensive digital colour CCTV system. All public areas of the licensed premises will be covered enabling frontal identification of every person entering in any light condition. The CCTV cameras shall continually record whilst the premises is open for licensable activities and during all times customers remain on the premises. All recordings shall be stored for a minimum period of 31 days with date and time stamping. A staff member who is conversant with the operation of the CCTV system shall be present on the premises at all times when they are open to the public. This staff member shall be able to show the police or the Licensing Authority recent data or footage with the absolute minimum of delay when requested.**
- 2. There shall be no promoted events on the premises. A promoted event is an event involving music and/or dancing where the musical entertainment is provided at any time between by a disc jockey or disc jockeys one or some of whom are not employees of the premises licence holder and/or the event is (independent of the premises licence holder) promoted to the general public.**
- 3. When the premises is carrying on licensable activities after 00:00 hours, at least 2 registered door supervisors are to be on duty from 21:00 until customers have left the premises.**
- 4. A written dispersal policy shall be in place and implemented at the premises to move customers from the premises and the immediate vicinity in such a way as to cause minimum disturbance or nuisance to neighbours.**
- 5. Prominent signage shall be displayed at all exits from the premises requesting that customers leave quietly.**
- 6. The Licence holder shall make available a contact telephone number to neighbouring properties and the City of London Licensing Team to be used in the event of complaints arising.**
- 7. A log shall be kept at the premises and record all refused sales of alcohol for reasons that the person(s) is, or appears to be, under 18 years of age. The log shall record the date and time of the refusal and the name of the member of staff who refused the sale. The log will be made available on request by the Police or an authorised officer of the City of London Corporation.**
- 8. A 'Challenge 25' Scheme shall operate to ensure that any person attempting to purchase alcohol who appears to be under the age of 25 shall provide documented proof that he/she is over 18 years of age. Proof of age shall only comprise a passport, a photo card driving licence, an EU/EEA national ID card or similar document, or an industry approved proof of age identity card.**

- 9. Customers permitted to temporarily leave and then re-enter the premises e.g. to smoke, shall not be permitted to take drinks or glass containers with them.**
- 10. There shall be no licensable activities on the terraces after midnight.**

Annex 4 - Plans

Ground Floor Plan

Reference: SG 400 G1 Licensing

Date: 16.05.2017

LICENSING

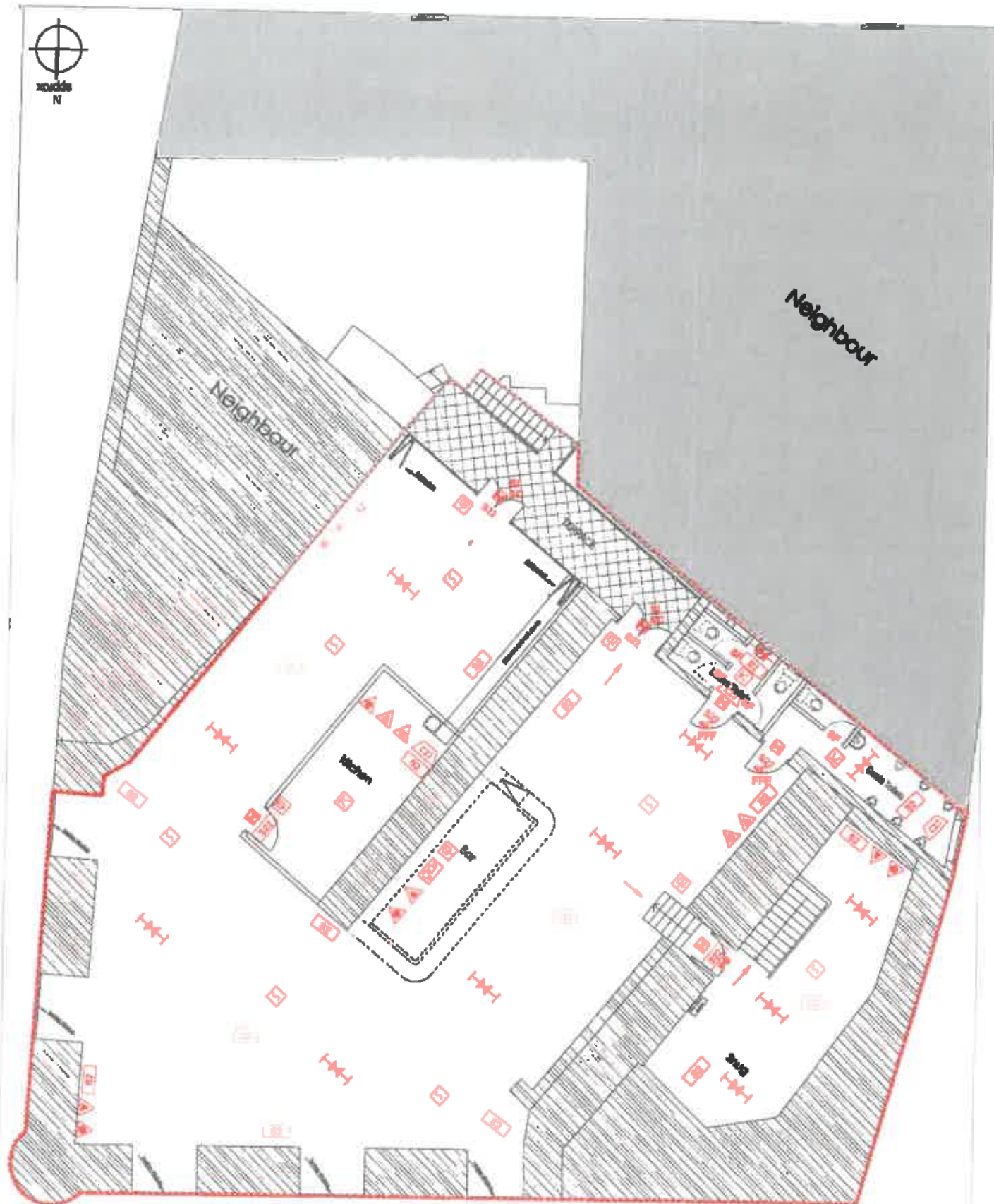

FIRST FLOOR PLAN - SCALE 1:100

M 1:100

0 1 2 3 4 5 6 7 8 9 10 [m]

antic

NOTES:

- All work to be carried out in accordance with current Building Regulations.
- All dimensions and levels to be checked on site before commencing any work.
- The drawings to be read in conjunction with contract documents, project working drawings, specifications and all amendments thereto and any other drawings, details and specifications.
- The company is acting on behalf of Antic London, 77 Maltham Road, Forest Hill, London.

Do not scale from this drawing

Antic London

Antic London
77 Maltham road,
Forest Hill
London, SE23 1AH

Address :
25A Barge Gardens, Tower Hill,
LONDON EC3N 3AN
Date:
15.04.2017

Drawing
Drawing no.
Scale

LICENSING

FIRST FLOOR plan
50 400 02 Licensing
1:100 @ A3